

# UNITY SCHOOLS PARTNERSHIP



## 2022

## Unity Day



Our keynote speakers:

---



**Sufian Sadiq**

Director of Teaching School,  
Chiltern Learning Trust



**Sam Strickland**

Headteacher,  
The Duston School



**Kate Jones**

Teacher, Leader & Author:  
Love to Teach, Retrieval Practice

---

EMAIL

[unityday@unitysp.co.uk](mailto:unityday@unitysp.co.uk)

**FRIDAY 1ST JULY 2022**

09.00 - 16.00

# UNITY SCHOOLS PARTNERSHIP



## Our vision

Unity Schools Partnership is a family of interdependent schools with a shared ambition to transform lives. Through geographical hubs of like-minded schools and a vision of excellence that is shared by all, schools smash through barriers to achieve more than others think possible.

It is our aim to:

- achieve the highest standards of education in our schools.
- be recognised locally and nationally for the exceptional quality of our educational provision
- develop a very high-quality, evidence-informed model of how excellence is achieved
- make remarkable change happen.

## Unity Day

Unity Day is an opportunity for staff from across the trust to come together to celebrate, collaborate and cultivate skills, knowledge and wellbeing. It's Unity's opportunity to say 'thank you' for all you contribute towards our shared vision and works towards one of our values: 'Staff are Delighted to be part of the Trust'. We truly hope you enjoy the day.

---

EMAIL  
[unityday@unitysp.co.uk](mailto:unityday@unitysp.co.uk)

**FRIDAY 1ST JULY 2022**  
09.00 - 16.00

# UNITY SCHOOLS PARTNERSHIP



## Unity Day Partners



Regional Training Centre

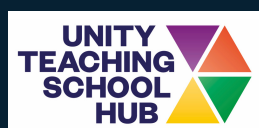

*celebrate, collaborate and cultivate*

EMAIL  
[unityday@unitysp.co.uk](mailto:unityday@unitysp.co.uk)

**FRIDAY 1ST JULY 2022**

09.00 - 16.00

# UNITY SCHOOLS PARTNERSHIP



## Unity Day Partners



Education Support are a charity with a mission to improve the mental health and wellbeing of teachers and education staff.

We support individuals and help schools, colleges and universities improve the mental health and wellbeing of staff. We also carry out research and advocate for changes in Government policy for the benefit of the education workforce.

Visit us to find out ways to improve the wellbeing of the teachers and education staff you work with. [www.Educationsupport.org.uk](http://www.Educationsupport.org.uk)



### Our Vision for Mental Health in Schools

Our vision is that all children and young people will achieve their full potential both personally and academically in a school where wellbeing is supported and positively encouraged.

OM Health and Wellbeing is a specialist consultancy service with over 25 years' experience of working with children, young people and their families. We're passionate about improving the health and wellbeing outcomes for children, young people and all school staff. We feel that because of the unique combination of our specialist skills, experience and expertise, we are ideally placed to realise this ambition in partnership with schools.

*celebrate, collaborate and cultivate*

EMAIL  
[unityday@unitysp.co.uk](mailto:unityday@unitysp.co.uk)

FRIDAY 1ST JULY 2022  
09.00 - 16.00



# UNITY SCHOOLS PARTNERSHIP

## Unity Day



Unity Day offers sessions across seven key themes. Focus on these themes empowers us to transform lives and make remarkable change happen.

### Equality, Diversity & Inclusion



*celebrate, collaborate and cultivate*

EMAIL  
[unityday@unitysp.co.uk](mailto:unityday@unitysp.co.uk)

**FRIDAY 1ST JULY 2022**  
09.00 - 16.00

# UNITY SCHOOLS PARTNERSHIP

## Your day



We want the day to be as flexible as possible, so that you can build a CPD day that works best for you. To help with this:

You choose 4 sessions, including 1 keynote. You then have 2 non-contact sessions: 1 for lunch, the other for growing your Unity network. After arriving, go straight to your first session; you choose when to have lunch out of 3 lunch slots (3, 4 or 5); 10 minutes are included to allow time to move between sessions and grab a drink on the way.

9.30 - 10.25	Session 1
10.35 - 11.30	Session 2
11.40 - 12.35	Session 3
12.45 - 13.40	Session 4
13.50 - 14.45	Session 5
14.55 - 15.50	Session 6

*celebrate, collaborate and cultivate*

EMAIL  
[unityday@unitysp.co.uk](mailto:unityday@unitysp.co.uk)

**FRIDAY 1ST JULY 2022**  
09.00 - 16.00

# UNITY SCHOOLS PARTNERSHIP



## Your day, your choices

### Making your session choices

- Consult the Unity Day session brochure, detailing each session or download the printer friendly PDF.
  - Use the Microsoft form to submit your preferences for the 6 sessions – please choose at least 4, including a Keynote.
- 

### Your schedule

Once we have all the choices in via the online form we will allocate you to a session based on your preferences. Wherever possible we will give you your choices in order of preference. We hope you understand that this may not always be possible – we will do this as fairly as we can. We will send you a list of your confirmed sessions before the event. Please download these to your phone or print them off and bring them with you to Unity Day.

*celebrate, collaborate and cultivate*

---

EMAIL  
[unityday@unitysp.co.uk](mailto:unityday@unitysp.co.uk)

**FRIDAY 1ST JULY 2022**  
09.00 – 16.00

## Location and transport

Unity Day will be hosted by Thomas Gainsborough School and Wells Hall Primary School.

Wells Hall Road, Great Cornard, -  
Sudbury, CO10 0NH

We are grateful to both schools for their commitment to making Unity Day a success.

### Travel by bus/coach

Due to pressure on parking, out of consideration to the schools' neighbours and as part of Unity's commitment to achieving 'Net Zero' we are asking all staff to travel by coach to Unity Day.

Travel Coordinators are arranging buses from each of the Unity secondary schools. You may travel from your nearest secondary school rather than traveling to your usual place of work. If you wish to do this, please let your school travel coordinator know so they can arrange this for you. If you require a parking space (ie for mobility reasons), please inform your school's travel coordinator. Travel coordinators are working together to ensure everyone has an appropriate means of travelling to and from the event.

*celebrate, collaborate and cultivate*

EMAIL  
[unityday@unitysp.co.uk](mailto:unityday@unitysp.co.uk)

**FRIDAY 1ST JULY 2022**  
09.00 - 16.00



# UNITY SCHOOLS PARTNERSHIP



## Transport FAQs

**If I live closer to the venue, do I have to go to my school first?**

No. If you're able to use public transport, walk to the venue or cycle, please do.

**If I live nearer another Unity school, could I travel on their coach?**

Yes. Talk to your Unity Day Travel Coordinator.

**Can we use our school minibuses?**

Yes. So long as you have a driver who has a minibus licence and they're insured to drive the Unity minibuses. Please complete all relevant risk assessments.

**If I have a mobility space, should I bring other people?**

Yes. If you have access to a parking space, we encourage you - where safe to do so - to carpool.

**Do we need to be on site all day?**

Unity staff are asked to attend 4 sessions, to include 1 keynote with 2 additional sessions for lunch and networking with colleagues. Unity Day transport will be provided at the start and end of the day. Where staff do not usually work on Fridays and / or require greater flexibility with timings, please discuss this with your line manager, or Headteacher.

*celebrate, collaborate and cultivate*

EMAIL

[unityday@unitysp.co.uk](mailto:unityday@unitysp.co.uk)

**FRIDAY 1ST JULY 2022**

09.00 - 16.00

# Parking Permits



There are a reasonable amount of parking spaces at the venue(s) but not enough for everyone, even if we were all to car-share. In addition, we are keeping an eye on our net-zero target and are keen to reduce the burden of traffic and congestion on the neighbouring residents, which has, in the past, caused them some inconvenience.

However, there are circumstances under which you may not be able to travel to the venue by bus from your nearest Unity secondary school e.g. you may have accessibility requirements, you may be presenting and need to be there earlier/later or have a car full of equipment, you are helping with set up/clear down, you are an external presenter and do not have a nearest secondary school.

Parking zones will be allocated to schools, with a proportionate number of parking spaces per school. If you require a parking space, please speak to your travel coordinator about a parking permit. Parking permits will be issued on a needs basis and anyone with a permit should endeavour to car share wherever possible.

**We would also ask that anyone driving to the venue help clear up and put classrooms back together afterwards.** Many hands make light work!

You will not be able to park at the venue without a valid parking permit.

## Presenters' parking

If you are presenting early or late and can't get the bus, or you have too much equipment, or you are an external presenter you will be allocated a parking space. Please car share where at all possible. If you intend to use public transport please let us know so we can reallocate your space.

*celebrate, collaborate and cultivate*

EMAIL  
[unityday@unitysp.co.uk](mailto:unityday@unitysp.co.uk)

**FRIDAY 1ST JULY 2022**  
09.00 - 16.00

## Time for lunch

To accommodate choices and make sure you have sufficient time between your workshops we have three lunch periods (3-5). Having taken into account the feedback from previous years' Unity Days, we have changed the format of lunchtime. We have arranged with an event caterer who's used to doing large **events to provide lunch (see next page for the menu).**

### Who's paying?

At registration, whether that's on the bus or as you enter the building, we will provide you with a token to use at the caterer of your choice. If you wish to purchase additional items to go with your meal, you are welcome to do so.

### Space to relax and eat

We will still have the lovely spacious marquee in which you can relax and eat your lunch and now that we are holding the event in July we are hoping the weather will be kind to us and you will be able to picnic on the grass, so should you wish, please bring a picnic blanket to share with your friends.

### Dietary requirements

To offer you a wide choice of things to eat, we have arranged a number of event trucks which will likely include:

- Burgers, vegan and vegetarian & other dietary requirements – let us know!
- Spud & Salad
- Special Dietary Requirements – preordered and served via TGS Deli Counter

### Let us know

Scan the QR code or use the link below to access the on the More Information Form:

<https://forms.office.com/r/biCQnjlj6V>



*celebrate, collaborate and cultivate*

# Burger Revolution

1

## Classic Burger

(with or without cheese)  
(Chilli Jam, burger sauce, lettuce, tomato pickle)

2

## Cajun Chicken

(Red pepper salsa, Lettuce, Chilli Jam, Tomato)

3

## Beyond Meat (vg/veg)

(Fig chutney, truffle mayo)  
(Add lettuce, Beetroot, Feta)

Lettuce wraps & gluten-free buns available - [let us know!](#)

## Add-ons:

Plain fries.....£2.50

Dirty fries.....£4.00  
(Crispy onions, Sriracha Mayo, Jalapenos)

Cheesy fries.....£4.00  
(Crispy onions, Sriracha Mayo, Jalapenos)

*celebrate, collaborate and cultivate*

EMAIL  
[unityday@unitysp.co.uk](mailto:unityday@unitysp.co.uk)

FRIDAY 1ST JULY 2022  
09.00 - 16.00



# Burger Alternatives

1

## Spud & Salad

Various fillings available (v/veg)  
Burgers not your thing? Choose a spud  
and salad - served from the Deli  
Counter. Let us know via the [online  
form](#).

2

## Special Dietary Requirements

Use the form to let us know!!



3

## Bring your own picnic

Be in charge of your lunch destiny....roll out your  
picnic blanket and settle down to a picnic you have  
prepared. Especially good if you have jam-packed  
your day so full of workshops that you haven't left  
time for lunch. Eat when you like and dodge the  
queues.

*celebrate, collaborate and cultivate*

# Refreshments



## Coffee anyone?

There will be complimentary tea and coffee stations throughout our venues for refreshment during your networking, lunch and relaxation time.

If posh coffee is your thing, bring some money to buy a latte, flat white or capuccino from the coffee vendor we have invited.



## Water

Bring a refillable water bottle and make use of the water stations that are positioned throughout the venues.



## You scream, ice-cream...

What better on a hot day than an ice-cream with all the trimmings? Or a juicy ice lolly to quench your thirst. We have arranged for an ice-cream van to be on site all day. Please bring money if you wish to buy an ice-cream.

*celebrate, collaborate and cultivate*

EMAIL  
[unityday@unitysp.co.uk](mailto:unityday@unitysp.co.uk)

**FRIDAY 1ST JULY 2022**  
09.00 - 16.00

# Things to bring....

## Suitable clothes & footwear



This is intended to be a relaxing day so please come smart-casual. For safety purposes, please do not wear open-toed footwear. You may need to walk between sites so check the weather report – will you need a coat/brolly? If you have booked a session that requires sports wear, please remember to bring this and get changed on site or wear your kit if you are happy to wear it all day. If you have chosen a swimming session in the lido, please bring swimwear and towels.

## Equipment & Your Schedule



Please bring your personalised schedule with you so you know what sessions you are doing, where and when. If you have chosen a session that requires equipment, we will advise you separately of this, using the email address you provided.



## Water bottle

Please bring a refillable water bottle and make use of the water stations to keep hydrated.



## Money

You can purchase additional food items, ice-cream and posh coffee



## Picnic blanket

If it's a nice day, you may wish to sit out on the grass to enjoy your lunch or during networking times. Therefore, please feel free to bring a picnic blanket to share with friends.

*celebrate, collaborate and cultivate*



# Presenters' Information

## Set up

We are opening our doors to presenters from 8am. Where possible, arrive 10 mins early for your presentation. There are 10 minutes between sessions. Check your room timetable, you may be able to get in earlier if you there is no one in the room before you.

## Equipment

There will be a laptop and screen in your room (if you are using a classroom - if you need to use your own laptop, please bring the necessary adaptor - all our screens are VGA connections.

If you need other equipment, or need your delegates to bring something, please let us know. Online form: <https://forms.office.com/r/biCQnj1j6V>



## Presentations

If you send us your presentation ahead of time (before Wednesday) we will be able to set it up on the laptop in your room so you only need to click the icon on the desktop.

## Money

We will provide you with a token for lunch and there will be complimentary coffee/tea stations and water coolers around and about, but you can purchase additional food items, ice-cream and posh coffee, so bring some pennies in case you wish to do so.

## Insurance

If you are an external presenter or are carrying out activities that might require insurance or a risk assessment, please let us have this in advance.

## Parking

You will need a parking permit. Please use the form to tell us or email: [UnityDay@unitysp.co.uk](mailto:UnityDay@unitysp.co.uk) with the subject line: Presenter Parking . We will need your vehicle registration number for your parking permit.

*celebrate, collaborate and cultivate*

EMAIL  
[unityday@unitysp.co.uk](mailto:unityday@unitysp.co.uk)

**FRIDAY 1ST JULY 2022**  
09.00 - 16.00





# Promo Stands' Information

## Set up

We are opening our doors to stand holders from 8am. We will provide you with a map of your stand location. If you have specific requirements for equipment, space (for large resources) please let us know in advance.

<https://forms.office.com/r/biCQnjIj6V>



## Money

We will provide you with a token for lunch and there will be complimentary coffee/tea stations and water coolers around and about, but **you** can purchase additional food items, ice-cream and posh coffee, so bring some pennies in case you wish to do so.

## Parking

You will need a parking permit. Please use the form to tell us or email: [UnityDay@unitysp.co.uk](mailto:UnityDay@unitysp.co.uk) with the subject line: **Promo Stand Parking**  
We will need the vehicle registration for your parking pass.

*celebrate, collaborate and cultivate*

EMAIL  
[unityday@unitysp.co.uk](mailto:unityday@unitysp.co.uk)

**FRIDAY 1ST JULY 2022**  
09.00 - 16.00



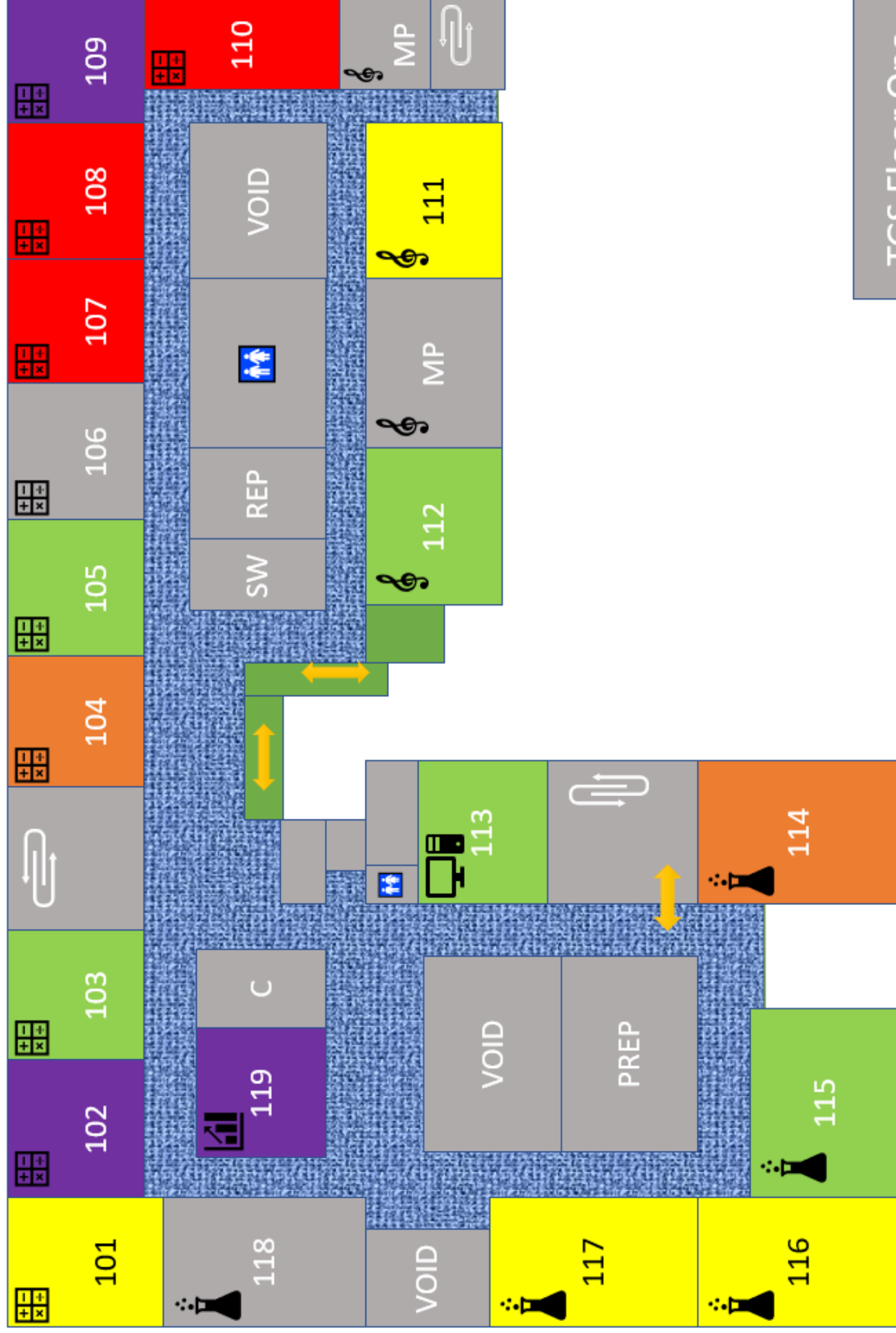

# TGS Floor One







# TGS Floor Three

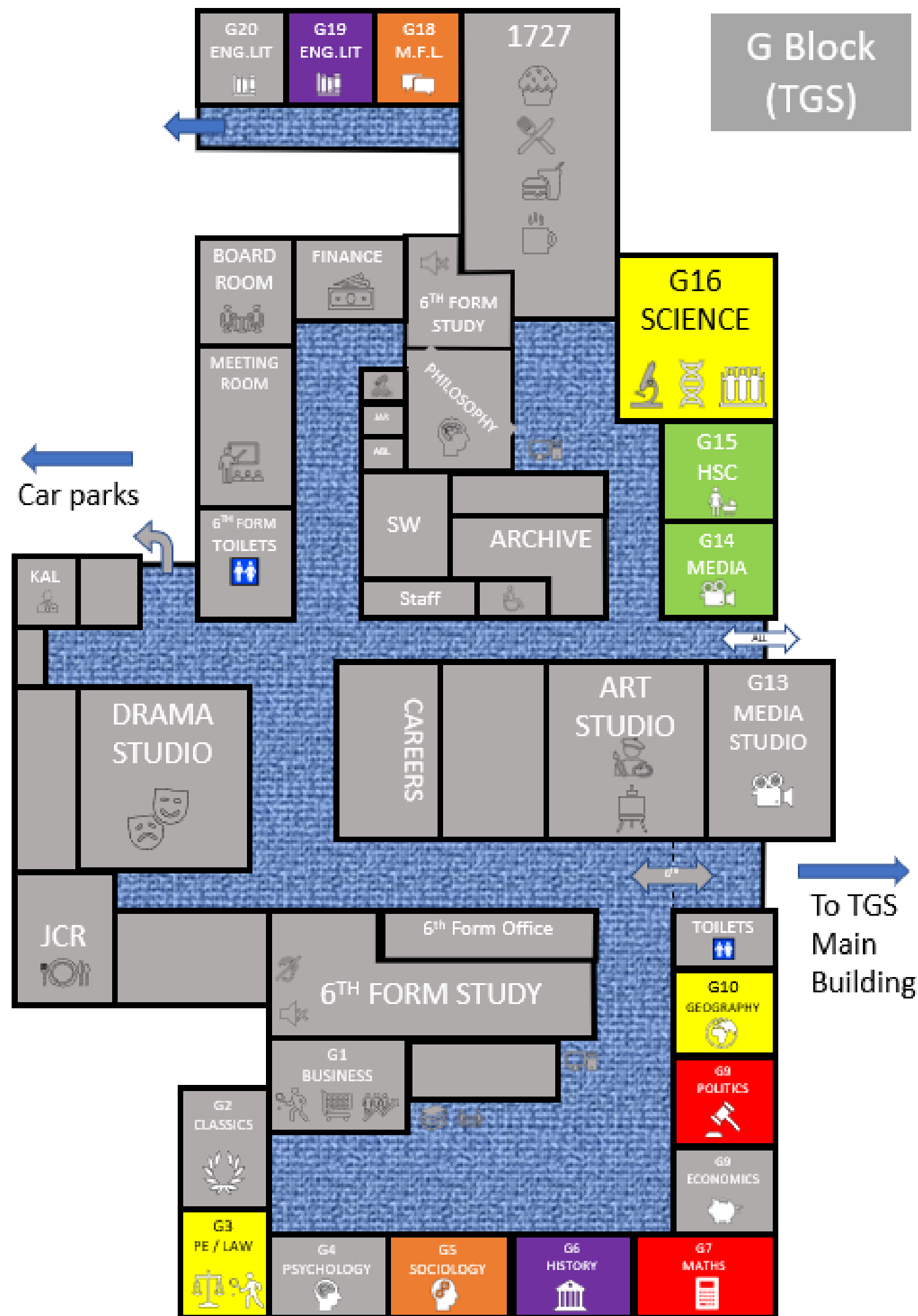

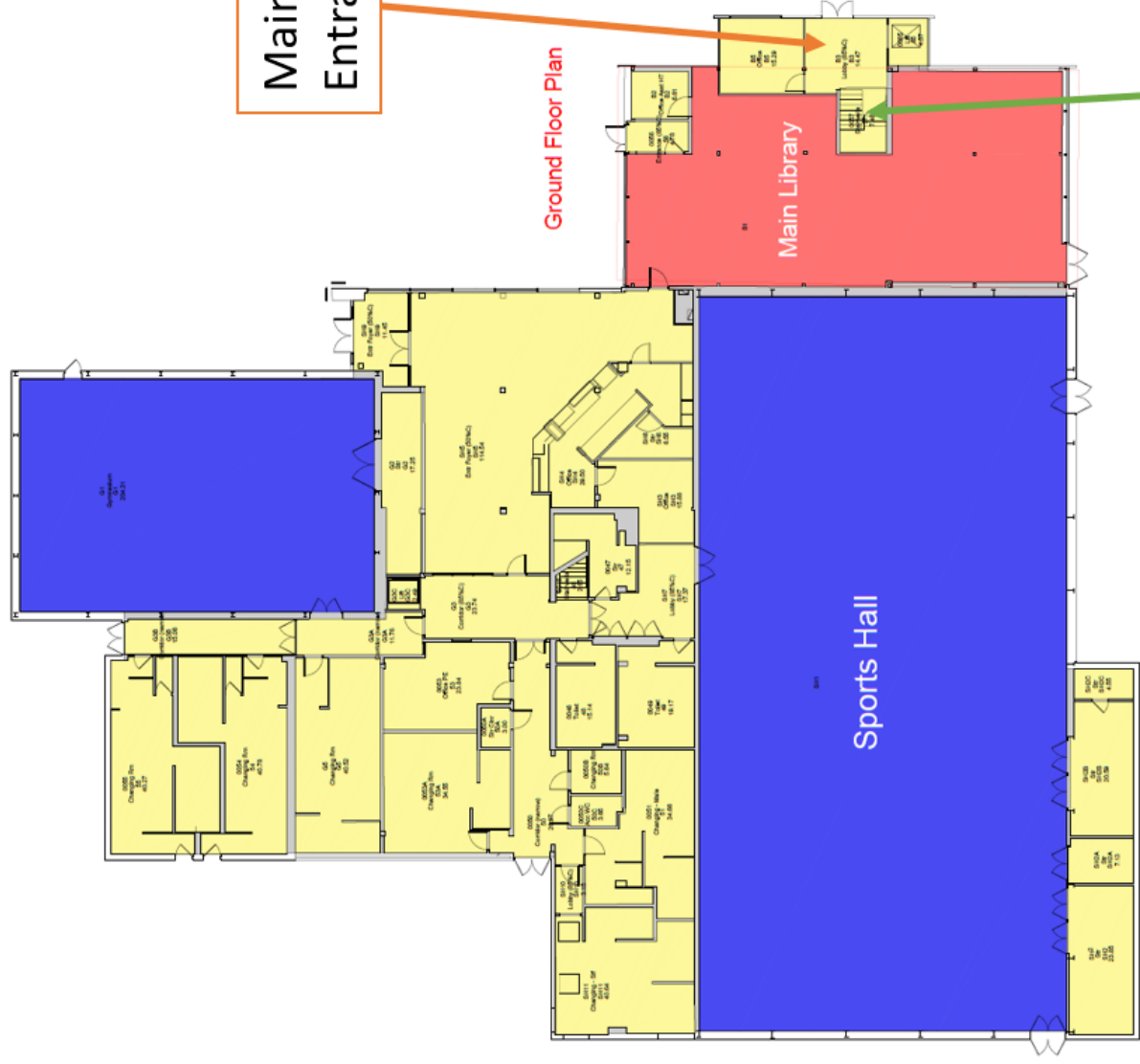

Ground Floor Plan

Main Entrance



Stairs to 1<sup>st</sup> floor



First Floor Plan

# Cornard Leisure Centre

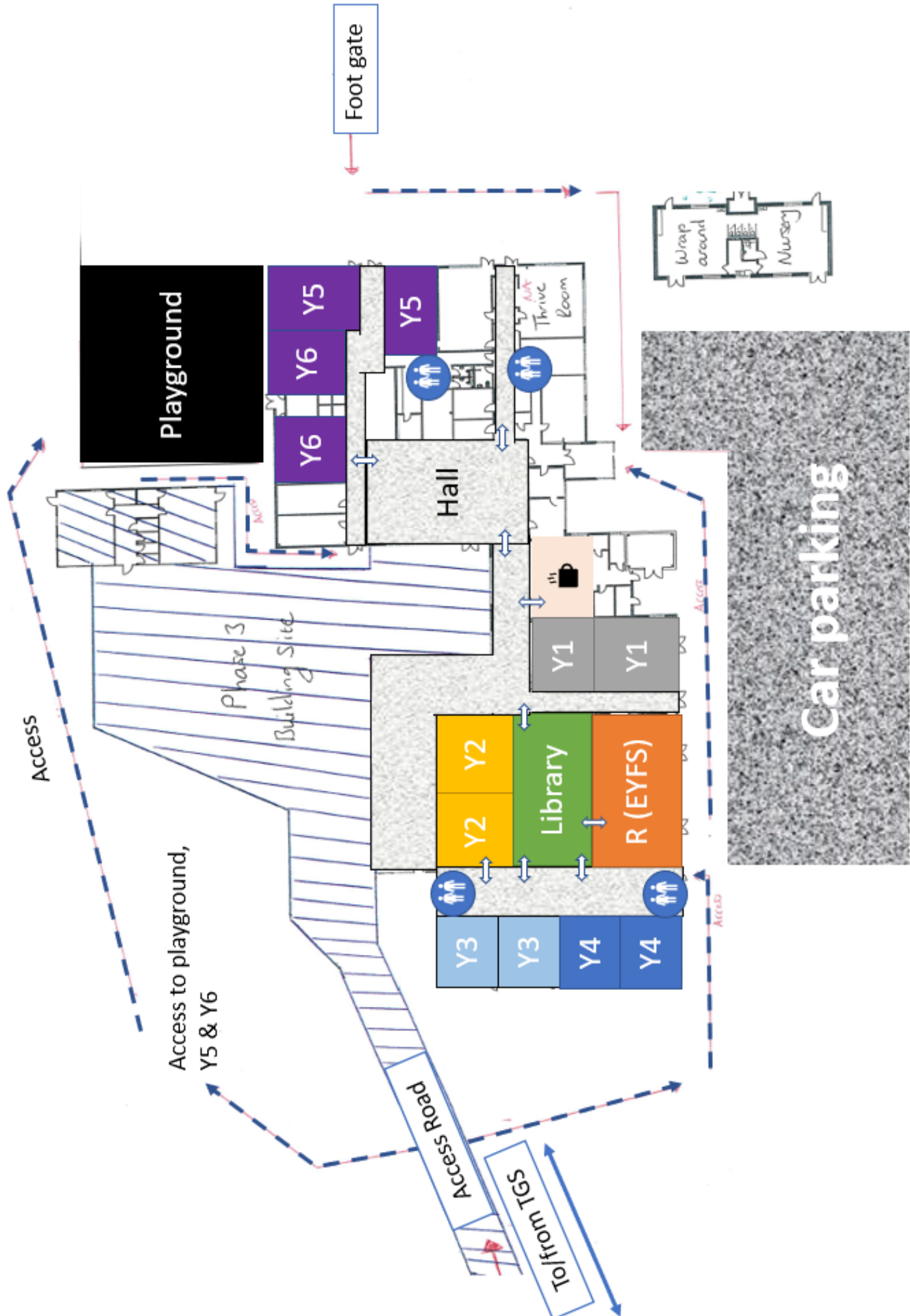



# Event venues

Wells Hall

Archery



G Block

Snack Shack



Burger Revolution



Marquee

Promo Stands

TGS

PS



Cornard Leisure Centre

Lido

Spuds & Salad  
(Snack Shack)



Gourmet Burgers  
(Burger Revolution)



Ice cream  
vendor



Posh coffee  
vendor



## N.B.

Use your food token to acquire a gourmet burger or jacket potato & salad on us and make the most of the complimentary tea & coffee available self serve inside each venue.

Buy add-on extras such as ice-cream, gourmet chips and posh coffee.

Promo stands

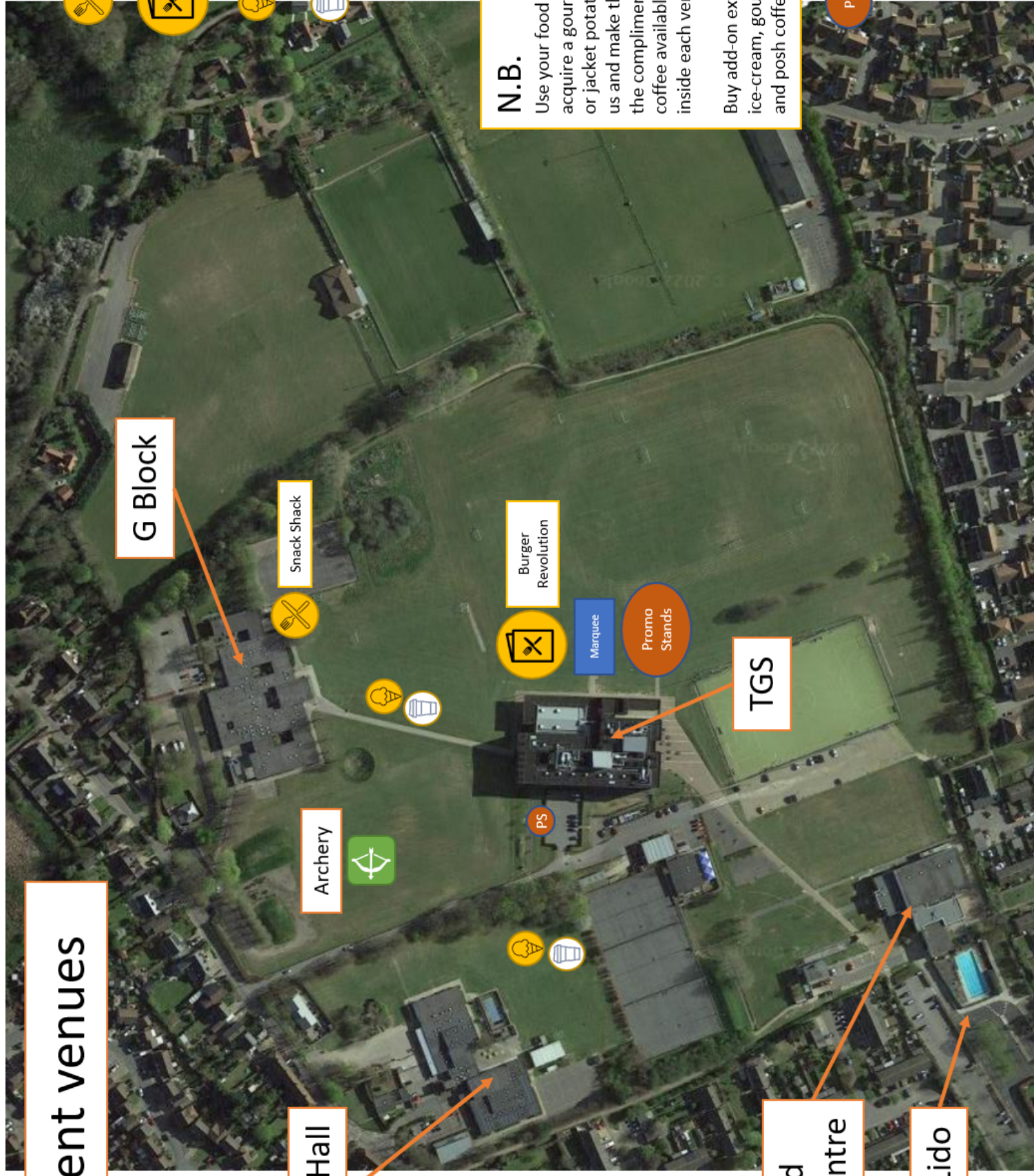



# Parking Locations

Cornard  
Dynamos FC  
Parking

Cornard Rugby  
Club Parking

G Block  
Parking

6<sup>th</sup> Form  
Car park

Visitor Parking

Beach Car Park

Wells Hall  
parking

Leisure Centre  
parking

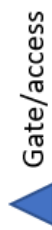





# UNITY SCHOOLS PARTNERSHIP

*celebrate, collaborate and cultivate*

---

EMAIL  
[unityday@unitysp.co.uk](mailto:unityday@unitysp.co.uk)

**FRIDAY 1ST JULY 2022**  
09.00 - 16.00